

FLUSH SOCKET

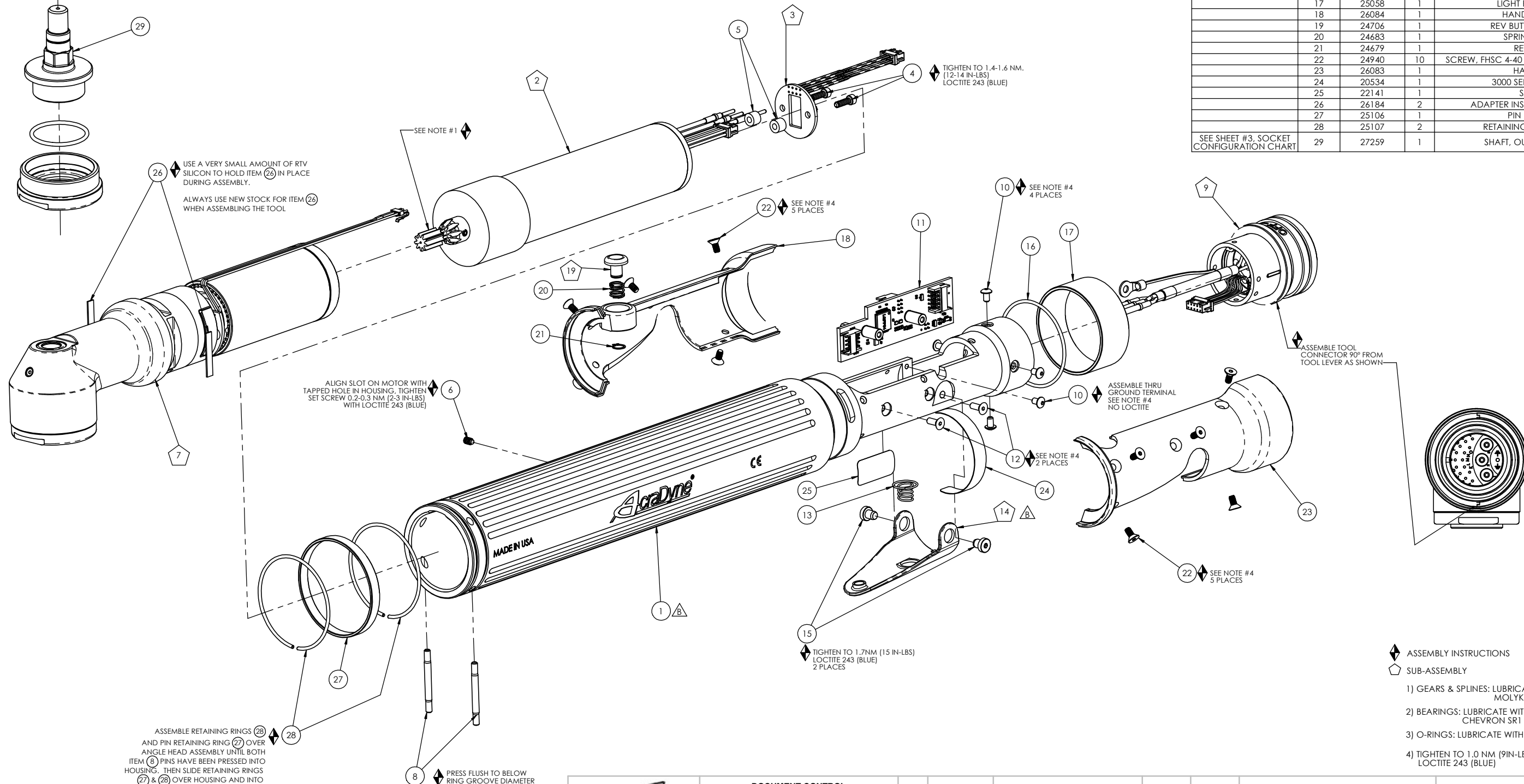

MODEL NO.	ANGLEHEAD/GEAR TRAIN ASM.
AEN33060CF	27611
AEN33090CF	27614

COMMENTS	ITEM NO.	PART NUMBER	QTY.	DESCRIPTION
	1	27031	1	MOTOR HOUSING ASSEMBLY
	2	25525	1	MOTOR ASSY, 9T, 3000 SERIES
	3	25063	1	LED BOARD ASM.
	4	25075	2	SCREW, SHC 4-40X.375, STEEL, BLACK OXIDE
	5	25430	2	STAND-OFF, LED, 3000 SERIES
	6	27027	1	SCREW, SET 5-40X.188, STEEL, BLK OXIDE
	7	SEE CHART	1	ANGLE HEAD, FLUSH SOCKET GEAR TRAIN ASM 90Nm
	8	26793	2	RETAINING PIN, .125 OD X 1-1/4
	9	26102	1	TOOL CONNECTOR ASM., LEVER
	10	25745	5	SCREW, BHSC 4-40 STEEL, BLACK OXIDE
	11	25847	1	TID BOARD ASM., 2000-3000 SERIES
	12	24934	2	SCREW, FHC 4-40 X .312, STEEL, BLACK OXIDE
	13	20132	1	THROTTLE SPRING
	14	26532	1	GEN 3 TRIGGER ASSY, CAST
	15	20061	2	SCREW, LEVER
	16	25072	1	O-RING, LED LIGHT RING COVER
	17	25058	1	LIGHT RING COVER, LED
	18	26084	1	HANDLE COVER, MFB
	19	24706	1	REV BUTTON SUB-ASSEMBLY
	20	24683	1	SPRING, REV BUTTON
	21	24679	1	RETAINING RNG
	22	24940	10	SCREW, FHSC 4-40 X .25 LG., STEEL, BLACK OXIDE
	23	26083	1	HANDLE COVER
	24	20534	1	3000 SERIAL/MODEL LABEL
	25	22141	1	SAFETY LABEL
	26	26184	2	ADAPTER INSERT, GEN 3B 3000 SERIES
	27	25106	1	PIN RETAINER RING
	28	25107	2	RETAINING RING, PIN RETAINER
SEE SHEET #3, SOCKET CONFIGURATION CHART	29	27259	1	SHAFT, OUTPUT, FLUSH SOCKET

26 USE A VERY SMALL AMOUNT OF RTV SILICON TO HOLD ITEM 29 IN PLACE DURING ASSEMBLY.
ALWAYS USE NEW STOCK FOR ITEM 26 WHEN ASSEMBLING THE TOOL

6 ALIGN SLOT ON MOTOR WITH TAPPED HOLE IN HOUSING, TIGHTEN SET SCREW 0.2-0.3 NM (2-3 IN-LBS) WITH LOCTITE 243 (BLUE)

4 TIGHTEN TO 1.4-1.6 NM. (12-14 IN-LBS) LOCTITE 243 (BLUE)

22 SEE NOTE #4 5 PLACES

10 SEE NOTE #4 4 PLACES

10 ASSEMBLE THRU GROUND TERMINAL SEE NOTE #4 NO LOCTITE

12 SEE NOTE #4 2 PLACES

15 TIGHTEN TO 1.7NM (15 IN-LBS) LOCTITE 243 (BLUE) 2 PLACES

22 SEE NOTE #4 5 PLACES

ASSEMBLE RETAINING RINGS 28 AND PIN RETAINING RING 27 OVER ANGLE HEAD ASSEMBLY UNTIL BOTH ITEM 8 PINS HAVE BEEN PRESSED INTO HOUSING. THEN SLIDE RETAINING RINGS 27 & 28 OVER HOUSING AND INTO GROOVES.

8 PRESS FLUSH TO BELOW RING GROOVE DIAMETER

- ◆ ASSEMBLY INSTRUCTIONS
- ◊ SUB-ASSEMBLY
- 1) GEARS & SPLINES: LUBRICATE WITH DOW CORNING MOLYKOTE BR2 PLUS GREASE.
- 2) BEARINGS: LUBRICATE WITH CHEVRON SRI GREASE
- 3) O-RINGS: LUBRICATE WITH O-RING LUBE
- 4) TIGHTEN TO 1.0 NM (9IN-LBS) LOCTITE 243 (BLUE)

REQUIRED TOOLING
LOCTITE 243 (BLUE)
1/16 HEX WRENCH
5/64 HEX WRENCH
3/32 HEX WRENCH
SNAP RING PLIERS - EXTERNAL TYPE



DOCUMENT CONTROL
PRINTED COPIES OF THIS DOCUMENT ARE CONSIDERED TO BE UNCONTROLLED DOCUMENTS. HOLDERS ARE RESPONSIBLE FOR VERIFYING THE CURRENT REVISION LEVEL WITH PURCHASING OR ENGINEERING PRIOR TO USE OR FABRICATION. THE CONTROLLED VERSION OF THIS DOCUMENT IS ELECTRONICALLY MAINTAINED.

PROPRIETARY AND CONFIDENTIAL
THIS DRAWING CONTAINS INFORMATION STRICTLY CONFIDENTIAL TO ACRADYNE/AIMCO. IN THE ABSENCE OF EXPRESSED WRITTEN PERMISSION, ACRADYNE/AIMCO HAS LOANED THIS COPY WITH THE MUTUAL UNDERSTANDING THAT (A) IT WILL NOT BE USED FOR ANY PURPOSE OTHER THAN FOR THAT IN WHICH IT WAS PROVIDED, (B) THE DATA CONTAINED HEREIN WILL NOT BE DISCLOSED TO OTHERS, (C) IT WILL NOT BE REPRODUCED, AND (D) IT WILL BE RETURNED TO ACRADYNE/AIMCO IMMEDIATELY UPON DEMAND.

REVISION LEVEL	REVISION RELEASE DATE	DESCRIPTION OF CHANGES MADE TO PART	ECN #	AUTHOR/ APPROVAL
REVISION BLOCK				

UNLESS OTHERWISE SPECIFIED, DIMENSIONS ARE IN INCHES
DIMENSIONS AND TOLERANCING PER ANSI Y14.5 SURFACE ROUGHNESS PER ANSI Y14.36

BLOCK TOLERANCING PER DECIMAL:
X = ±.030 XX = ±.010 XXX = ±.005 XXXX = ±.0005
ANGLE = ±0° 30'

REMOVE BURRS AND SHARP EDGES: R.015 MAX MACHINE SURFACE FINISH: 125 RMS OR BETTER

DRAWINGS AND TECHNICAL DOCUMENTS CONTROLLED BY:
ACRADYNE MECHANICAL ENGINEERING

AEN330_CF FLUSH HEAD NUTRUNNER 3000 SERIES - GEN 3C		
SIZE D	PART / DRAWING NUMBER AEN330_CF	REVISION B
SCALE: 1:1	DO NOT SCALE DRAWING	SHEET 1 OF 3

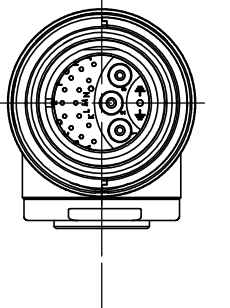
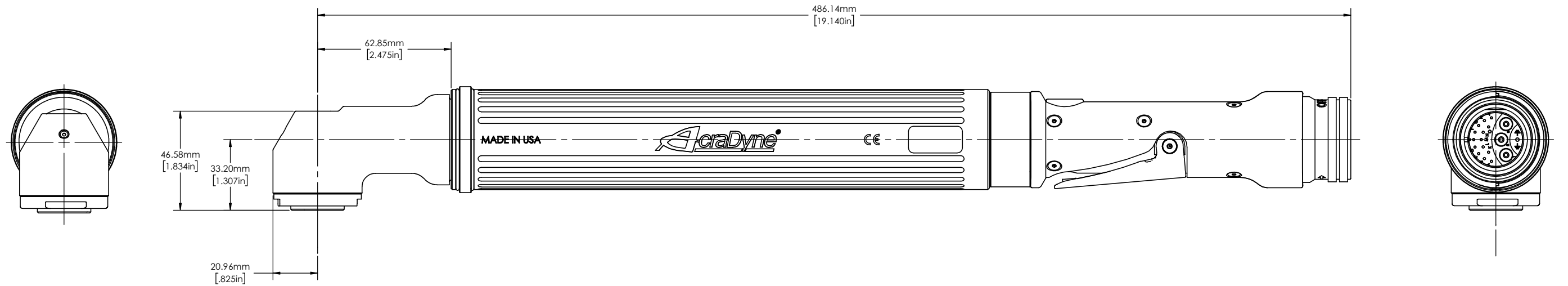

DOCUMENT CONTROL
 PRINTED COPIES OF THIS DOCUMENT ARE CONSIDERED TO BE UNCONTROLLED DOCUMENTS. HOLDERS ARE RESPONSIBLE FOR VERIFYING THE CURRENT REVISION LEVEL WITH PURCHASING OR ENGINEERING PRIOR TO USE OR FABRICATION. THE CONTROLLED VERSION OF THIS DOCUMENT IS ELECTRONICALLY MAINTAINED.

PROPRIETARY AND CONFIDENTIAL
 THIS DRAWING CONTAINS INFORMATION STRICTLY CONFIDENTIAL TO ACRADYNE/AIMCO. IN THE ABSENCE OF EXPRESSED WRITTEN PERMISSION, ACRADYNE/AIMCO HAS LOANED THIS COPY WITH THE MUTUAL UNDERSTANDING THAT (A) IT WILL NOT BE USED FOR ANY PURPOSE OTHER THAN FOR THAT IN WHICH IT WAS PROVIDED, (B) THE DATA CONTAINED HEREIN WILL NOT BE DISCLOSED TO OTHERS, (C) IT WILL NOT BE REPRODUCED, AND (D) IT WILL BE RETURNED TO ACRADYNE/AIMCO IMMEDIATELY UPON DEMAND.

REVISION LEVEL	REVISION RELEASE DATE	DESCRIPTION OF CHANGES MADE TO PART	ECN #	AUTHOR/ APPROVAL

UNLESS OTHERWISE SPECIFIED, DIMENSIONS ARE IN INCHES
 DIMENSIONS AND TOLERANCING PER ANSI Y14.5
 SURFACE ROUGHNESS PER ANSI Y14.36

BLOCK TOLERANCING PER DECIMAL:
 .X = ±.030 .XX = ±.010 .XXX = ±.005 .XXXX = ±.0005
 ANGLE = ±0° 30'

REMOVE BURRS AND SHARP EDGES: R.015 MAX
 MACHINE SURFACE FINISH: 125 RMS OR BETTER

DRAWINGS AND TECHNICAL DOCUMENTS CONTROLLED BY:
ACRADYNE MECHANICAL ENGINEERING

AEN330_CF FLUSH HEAD NUTRUNNER
 3000 SERIES - GEN 3C

SIZE D	PART / DRAWING NUMBER AEN330_CF	REVISION B
SCALE 1:4	DO NOT SCALE DRAWING	SHEET 2 OF 3

BASE MODEL	DOT	SOCKET BASE	COLUMN 1	SOCKET SIZE	COLUMN 2	EXT.	COLUMN 3	MAGNET	COLUMN 4
AEN33060CF	.	X	DRIVE TYPE	X	HEX SIZE	X	EXTENSION LENGTH	X	MAGNET OPTION
		A	27259 SINGLE HEX	A	10mm	A	0	0	NO MAGNET
		B	27259 DOUBLE HEX	B	11mm	B	3mm	1	WITH MAGNET
		C	27259 SURFACE DRIVE	C	12mm	C	6mm		
				D	13mm	D	9mm		
				E	14mm	E	12mm		
				F	15mm	F	15mm		
				G	16mm	G	18mm		
				H	17mm	H	21mm		
				I	7/16"	I	24mm		
				J	1/2"	J			
				K	9/16"	K			
				L	5/8"	L			
				M	11/16"	M			
				N		N			
				P		P			
				Q		Q			
				R		R			
				S		S			
				T		T			
				U		U			
				V		V			
				W		W			
				X		X			
				Y		Y			
				Z		Z			

****EXAMPLE MODEL NUMBER:** AEN33060CF.CEG0 = SURFACE DRIVE, 14mm HEX, 18mm EXT., NO MAGNET



DOCUMENT CONTROL
 PRINTED COPIES OF THIS DOCUMENT ARE CONSIDERED TO BE UNCONTROLLED DOCUMENTS. HOLDERS ARE RESPONSIBLE FOR VERIFYING THE CURRENT REVISION LEVEL WITH PURCHASING OR ENGINEERING PRIOR TO USE OR FABRICATION. THE CONTROLLED VERSION OF THIS DOCUMENT IS ELECTRONICALLY MAINTAINED.

PROPRIETARY AND CONFIDENTIAL
 THIS DRAWING CONTAINS INFORMATION STRICTLY CONFIDENTIAL TO ACRADYNE/AIMCO. IN THE ABSENCE OF EXPRESSED WRITTEN PERMISSION, ACRADYNE/AIMCO HAS LOANED THIS COPY WITH THE MUTUAL UNDERSTANDING THAT (A) IT WILL NOT BE USED FOR ANY PURPOSE OTHER THAN FOR THAT IN WHICH IT WAS PROVIDED, (B) THE DATA CONTAINED HEREIN WILL NOT BE DISCLOSED TO OTHERS, (C) IT WILL NOT BE REPRODUCED, AND (D) IT WILL BE RETURNED TO ACRADYNE/AIMCO IMMEDIATELY UPON DEMAND.

REVISION LEVEL	REVISION RELEASE DATE	DESCRIPTION OF CHANGES MADE TO PART	ECN #	AUTHOR/ APPROVAL

UNLESS OTHERWISE SPECIFIED, DIMENSIONS ARE IN INCHES
 DIMENSIONS AND TOLERANCING PER ANSI Y14.5
 SURFACE ROUGHNESS PER ANSI Y14.36

BLOCK TOLERANCING PER DECIMAL:
 .X = ±.030 .XX = ±.010 .XXX = ±.005 .XXXX = ±.0005
 ANGLE = ±0° 30'

REMOVE BURRS AND SHARP EDGES: R.015 MAX
 MACHINE SURFACE FINISH: 125 RMS OR BETTER

DRAWINGS AND TECHNICAL DOCUMENTS CONTROLLED BY:
ACRADYNE MECHANICAL ENGINEERING

AEN330__CF FLUSH HEAD NUTRUNNER
 3000-SERIES - GEN 3C

SIZE B	PART / DRAWING NUMBER AEN330__CF	REVISION B
SCALE 1:4	DO NOT SCALE DRAWING	SHEET 3 OF 3